

NR0-Rn, NR1-Rn, NR2-Rn



WARNING

1. The installation and adjustment of the electric motor must be carried out by qualified personnel, using the device in the manner described.
2. This motor is not suitable for use by the following people (including children): people with physical or mental disabilities, sensory disabilities, or people who lack experience and knowledge of the product.
3. Do not use or stop using if the application and/or the product is damaged, especially if it has damage to the cable and covers. If the cord is damaged, it must be replaced by the manufacturer, its service agent or qualified personnel, in order to avoid a hazard.
4. Do not operate the equipment during maintenance programs.
5. When operating the electric motor, make sure there are no people in the area before the shade closes completely.
6. During installation, the horizontal distance of at least 0.4 m must be maintained between the first moving part anchored to the motor and the fixed parts.
7. During the use and installation of the electric motor, all cables must not touch the blind. Keep the radio reception antenna in good condition. (Do not cut or place the antenna around metal materials, otherwise reception may be affected.)
8. The motor should be kept in a dry place; The remote control battery should be replaced with a new one once it runs out, otherwise it will affect the transmission distance. Replace the battery as soon as the control transmission distance is reduced.
9. When the electric motor is moving the app "up", it is forbidden to press the "down" button directly.
10. Before performing any type of maintenance, turn off the power supply to the motor and discontinue use of the controls.
11. If you have any questions about the installation and operation of the manufacturer's electric motor, or accessories, visit www.tecnoshades.com for your consultation.
12. The manufacturer declares that this product is in compliance with the essential requirements and other relevant regulations 1999/5/EC.

INSTALLATION

1. The electric motor must be installed in a dry and ventilated environment.
2. Before installation, check that the moving parts have good mechanical properties, balance properties, and good opening and closing performance. Make sure the electricity meets the product specifications.
3. Check whether the size and shape of the adapters (wheel and crown) match the tube, and make sure all the accessories are fixed, and do not cause any mechanical hindrance to the motor.
4. After the motor is inserted into the tube, fix the wheel and ring gear to the tube to ensure there is no relative movement between the three components.
5. Install the electric motor and tube above the window or door; Attach the mounting brackets to the wall on each side with screws. Keep the electric motor and tube horizontal, and the tube should be perpendicular to each side of the door or window.
6. Installation diagram.

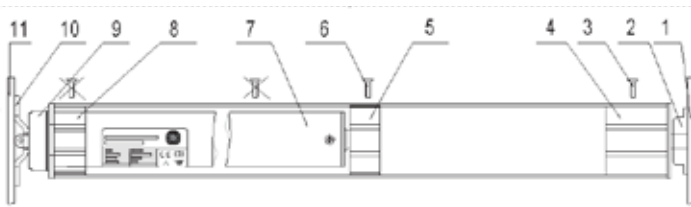

1. Wall or panels
2. Bearing
3. Screw or rivet
4. Final shaft with wheel or cover
5. Drive wheel
6. Screw or rivet
7. Tubular motor
8. Crown
9. Motor head for wall
10. Star plate
11. Wall or panels

7. The outlet plug must be equipped and grounded. Connection diagram:

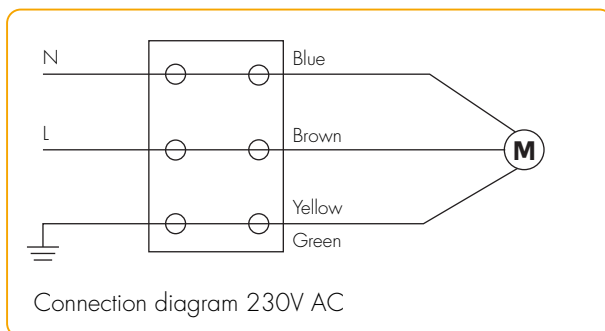

Connection diagram 230V AC

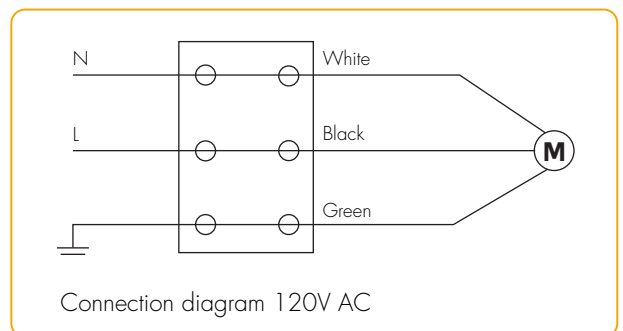

Connection diagram 120V AC

8. The installation of the motor must be correct and reliable. The shade should be able to move smoothly through its gutters without hindrance.



PROGRAMMING

The following programming instructions must be carried out step by step.

If the power supply was suspended or timed out before the third step, you must start from the first step after restoring the power supply.

Feedback = cycle: It is a short movement of the electric motor up and down.

Register the first remote control on a tubular motor

Step 1. Energize the motor.

Step 2. Press the UP, DOWN buttons on the remote at the same time.

Step 3. A feedback motion will confirm that the remote has been temporarily enrolled in the memory of the tubular motor.

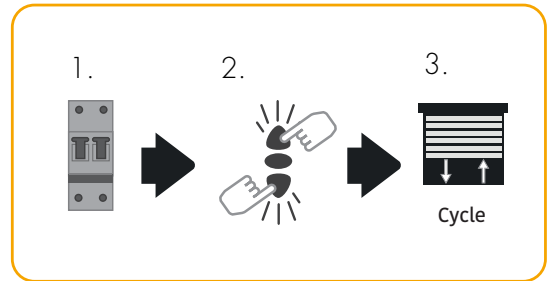

Note: The procedure must be performed within 2 minutes after turning on the power supply or resetting the electric motor.

CHANGING THE DIRECTION OF ROTATION

If the direction of rotation is correct

Step 1. Use a thin tool to press the PROG button for 2 seconds, until the electric motor cycle.

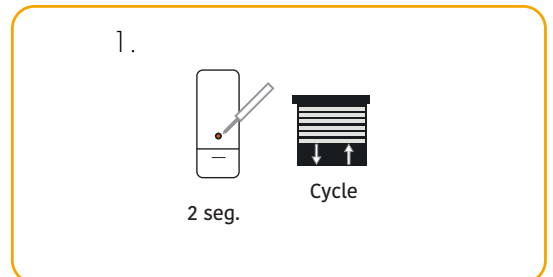

If the direction of rotation is incorrect

Step 1. Press the STOP button for 2 seconds, until the electric motor cycles, the direction of rotation was reversed.

Step 2. Press the PROG button for 2 seconds, until the electric motor cycles.

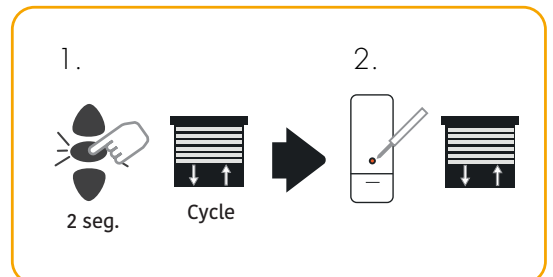

Notes: The procedure must be performed within 2 minutes after registering the first remote control.

The direction of rotation can be reversed over and over again by pressing the STOP button for 2 seconds before confirming the PROG button for 2 seconds.

The direction of rotation must be confirmed by pressing the PROG button for 2 seconds, and then continue with the programming procedure.



SET THE LIMITS OF STROKE

Set upper limit

Step 1. Press the UP and STOP button until the electric motor cycles.

Step 2. Using the UP or DOWN buttons move the motor where you want to set the upper limit.

Step 3. Press the PROG button for 2 seconds, until the electric motor cycles.

Note: the procedure must be performed after confirming the direction of rotation. The order of setting limits does not matter.

Before setting stroke limits, the electric motor runs in stepping mode.

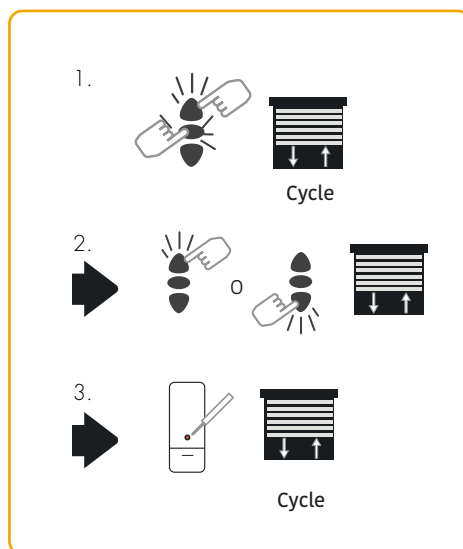

Set lower limit

Step 1. Press the DOWN and STOP button until the electric motor cycles.

Step 2. Using the UP or DOWN buttons move the motor where you want to set the lower limit.

Step 3. Press the PROG button for 2 seconds, until the electric motor cycles.

Note: The procedures must be performed within 2 minutes, otherwise the electric motor will cycle and return to the previous state.

Programming can be canceled by pressing "UP+STOP+DOWN" for 0.5 seconds before confirming by pressing the PROG button for 2 seconds.

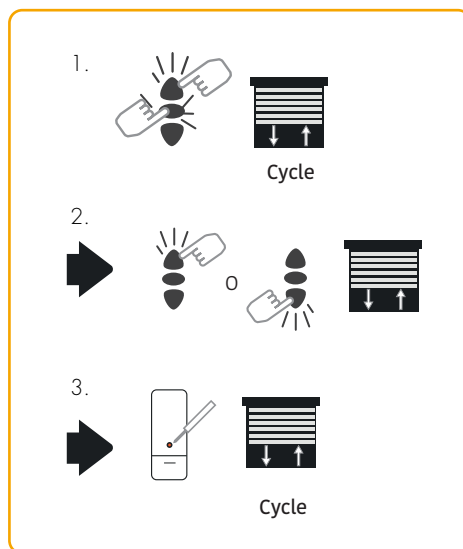

MODO USER MODE

ADD A REMOTE

Step 1. Press the programming button with a thin tool on the already registered remote/channel for four seconds, until the motor cycles.

Step 2. Select the new remote/channel you wish to add and press its PROG button for two seconds, until the motor cycles.

Note: You can add up to 12 remote controls to one electric motor.

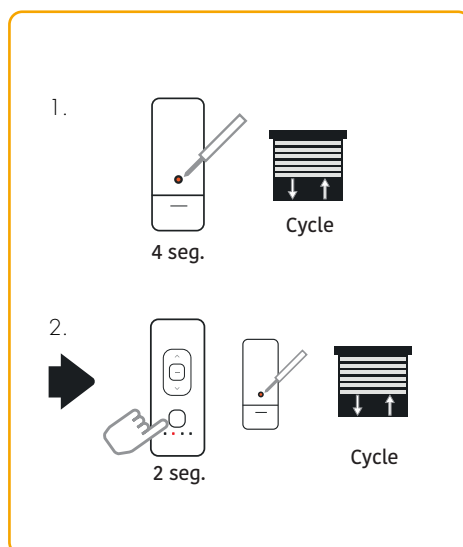



DELETE A REMOTE CONTROL

Step 1. Press the programming button with a thin tool on the already registered remote/channel for four seconds, until the motor cycles.

Step 2. Select already registered remote/channel you want to delete and press its PROG button for two seconds, until the motor cycles, the remote/channel has been deleted.

Note: A remote cannot delete itself.

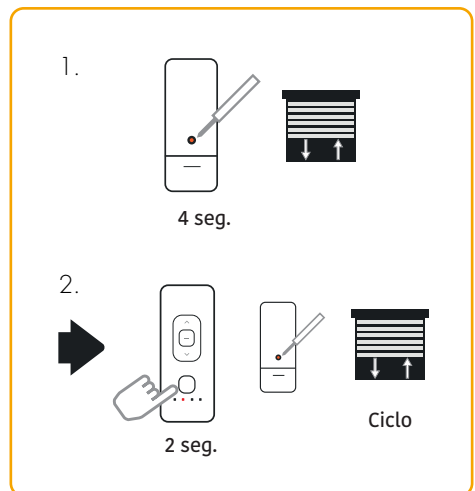

USER MODE

SET THE LIMITS OF STROKE

Modify the upper limit

Step 1. Press the PROG button for four seconds, until the electric motor cycles.

Step 2. Press the UP and STOP button for two seconds, until the motor cycles.

Step 3. Press the UP or DOWN button then stop the motor where you want to set the new limit.

Step 4. Press the PROG button for two seconds until the electric motor cycles.

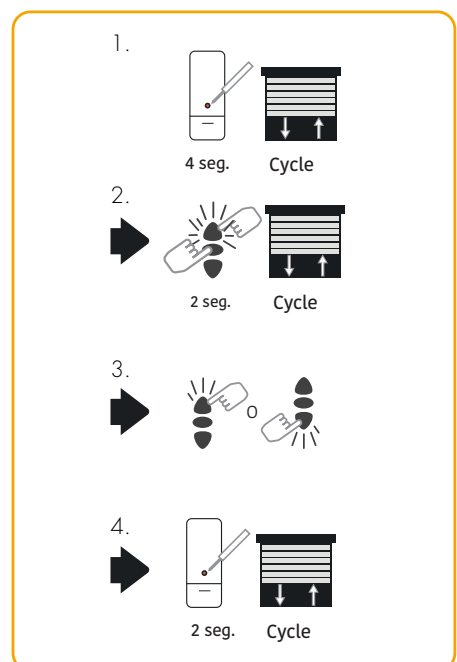

Modify the lower limit

Step 1. Press the PROG button for four seconds, until the electric motor cycles.

Step 2. Press the DOWN and STOP button for two seconds, until the motor cycles.

Step 3. Press the UP or DOWN button then stop the motor where you want to set the new limit.

Step 4. Press the PROG button for two seconds until the electric motor cycles.

Note: In the adjustment process the electric motor works in stepping mode.

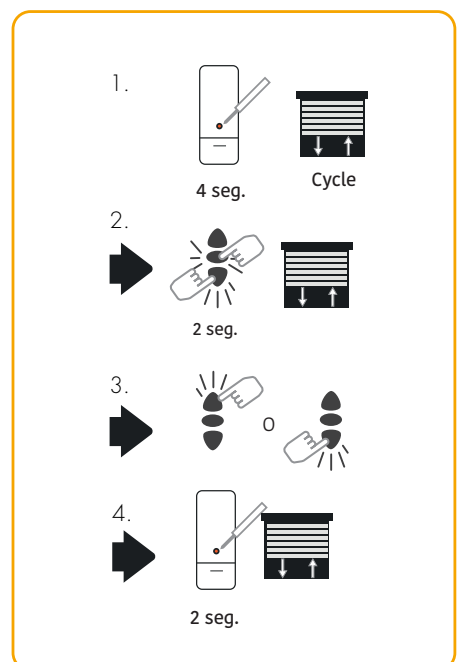



CHANGING THE DIRECTION OF ROTATION

Step 1. Press the PROG button for four seconds until the electric motor cycles.

Step 2. Press the STOP button for two seconds until the electric motor cycles.

Step 3. Press the PROG button for two seconds until the electric motor cycles.

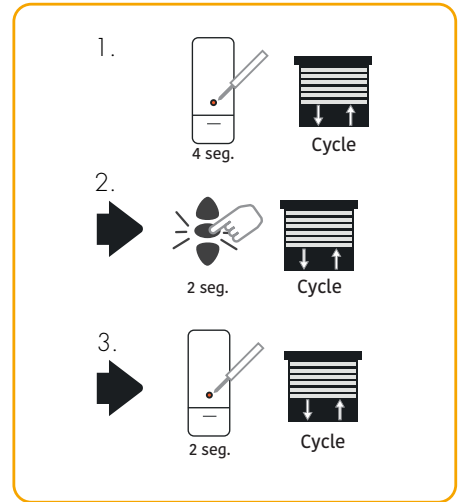

REPLACE THE REMOTE CONTROL

Step 1. Disconnect the power supply for 2 seconds.

Step 2. Connect the power supply for 5 to 15 seconds.

Step 3. Disconnect the power supply for 2 seconds.

Step 4. Connect the power supply, the motor will cycle.

Step 5. Press the PROG button on the new remote for 0.5 seconds, until the electric motor cycles; The new remote has been programmed and all registered remotes will be deleted.

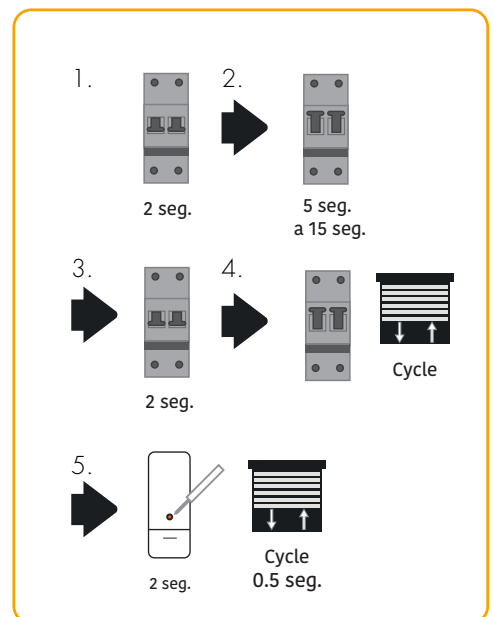

Note: The operation will delete all registered remote controls; however the motor will retain the stroke limits.

RESET ENGINE

Step 1. Press the PROG button for four seconds, until the motor cycles.

Step 2. Press the UP and DOWN buttons at the same time for 2 seconds, until the motor cycles.

Step 3. Press the PROG button for 2 seconds, until the electric motor cycles.

Notes: Any other operation will interrupt the reset process.

The procedure will remove all registered remote controls and stroke limits, the engine will return to factory condition.

After the electric motor is reset, you have two minutes to register a remote (see step 1, "Initial Programming").

